



---

# SRP

# Business Square

*"A Space for Every Ambition"*

SHOPS | OFFICES | COMMERCIAL SPACES



# SRP Business Square



Manchar, Pune District





# About \* SRP Developers

For over 20 years, SRP Developers has been a trusted name in real estate, delivering exceptional quality in residential and commercial developments across Pune and beyond. Our commitment to excellence, transparency, and customer satisfaction has helped us build a strong legacy of more than 95 completed projects and 3.5 million square feet of space developed.

## Key Achievements



Over 20 years of  
Industry Experience

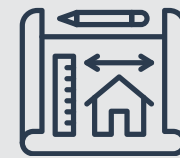

95+ completed  
projects



A trusted name in  
Residential and  
Commercial  
Developments



Focused on  
creating value for  
clients and  
communities



---

# Brand \* Philosophy

"Welcome to SRP Business Square. We are proud to present a project that reflects our core values of trust, excellence, and quality. At SRP Developers, we've been shaping the real estate landscape for over 20 years. This development is designed to meet the growing demand for premium business spaces in Pune and its surrounding areas. We invite you to be a part of this exciting journey."

— Team SRP







# *A Legacy of* **Excellence**

With a history spanning over 20 years, SRP Developers is a trusted name in the real estate industry, known for its commitment to quality, reliability, and customer satisfaction. Our portfolio includes a diverse range of residential and commercial projects, each one designed with the goal of improving quality of life and boosting business potential.

## Notable

### *Completed Projects*

- ✓ **Prarambh Yash Vrindavan:** A commercial hub designed to foster business growth and success.
- ✓ **Shubha Arambha, Lohegoan:** Offering thoughtfully crafted spaces for a fulfilling lifestyle.
- ✓ **Kadam Avenue:** Offering peaceful living with modern comfort and lifestyle.
- ✓ **Mauli Complex:** Offering a lifestyle of comfort and tranquility.
- ✓ **Shiv Anagan:** Thoughtfully designed space that embodies elegance and convenience.



## Notable

### *Ongoing Projects*

- ✓ **Raya Residency:** A modern residential community known for convenience and comfort.
- ✓ **Onella Tower:** Blend of modern living and timeless elegance.
- ✓ **Infini Jagtap City:** A multi-use complex in Pune with state-of-the-art facilities.
- ✓ **Matoshri Serenity:** A residential project set amidst lush greenery for a peaceful living experience.
- ✓ **SRP Ayodhyam:** A future project set to redefine sustainable living.



L

E

G

A

C

Y

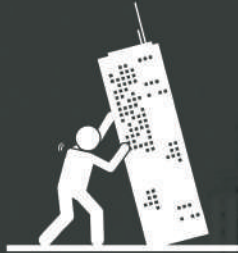
2004 -  
2009

**Establishing the Foundation :**  
SRP Developers Founded with a  
Mission to deliver Quality and  
Trust

Our goal since day one is to keep  
growing sustainably

2010-  
2016

**Expansion & Growth:** Reached the  
Milestone of delivering **1000+**  
Homes

**Diverse Ventures & Responsibility:**  
Developed over **3.5** million sq.ft  
Across residential and Commercial  
Projects

2016-  
2024

**Innovation and Future Growth:**  
Celebrating **20** years of Legacy,  
with **95+** Residential , Commercial  
and Government Projects and **20+**  
Acres of Upcoming Development.



# VISION

At SRP Developers, our vision is to  
create a legacy of trust and  
excellence by delivering innovative  
spaces that redefine urban living  
and business. Guided by our  
commitment to quality,  
sustainability, and customer  
satisfaction, we aspire to develop  
landmark projects that empower  
communities, foster growth, and  
shape the future.



# Strategic Location

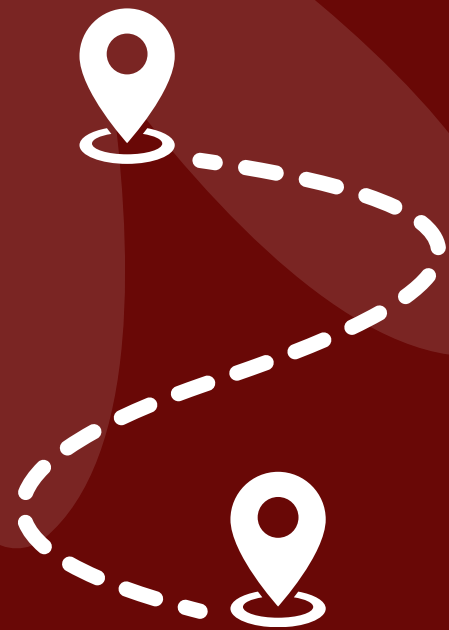

## Why Location Matters for Your Business:

A prime location increases footfall and ensures your business is easily reachable for customers, suppliers, and employees. SRP Business Square, located near the bustling Pune-Nashik Highway (NH-60), offers unparalleled visibility and convenience.

Manchar offers strategic benefits at a fraction of the cost, ensuring better returns on your investment while maintaining proximity to industrial and business hubs like Chakan and Khed MIDC.

## Nearby Connections :

NH 60: Just 5 minutes away for quick travel to Pune and Mumbai.

Close to Industrial Zones: Chakan and Khed MIDC.



Local Facilities: Proximity to hospitals, banks, and restaurants ensures convenience.

An emerging area with rapid infrastructure development, making it an ideal choice for future growth.



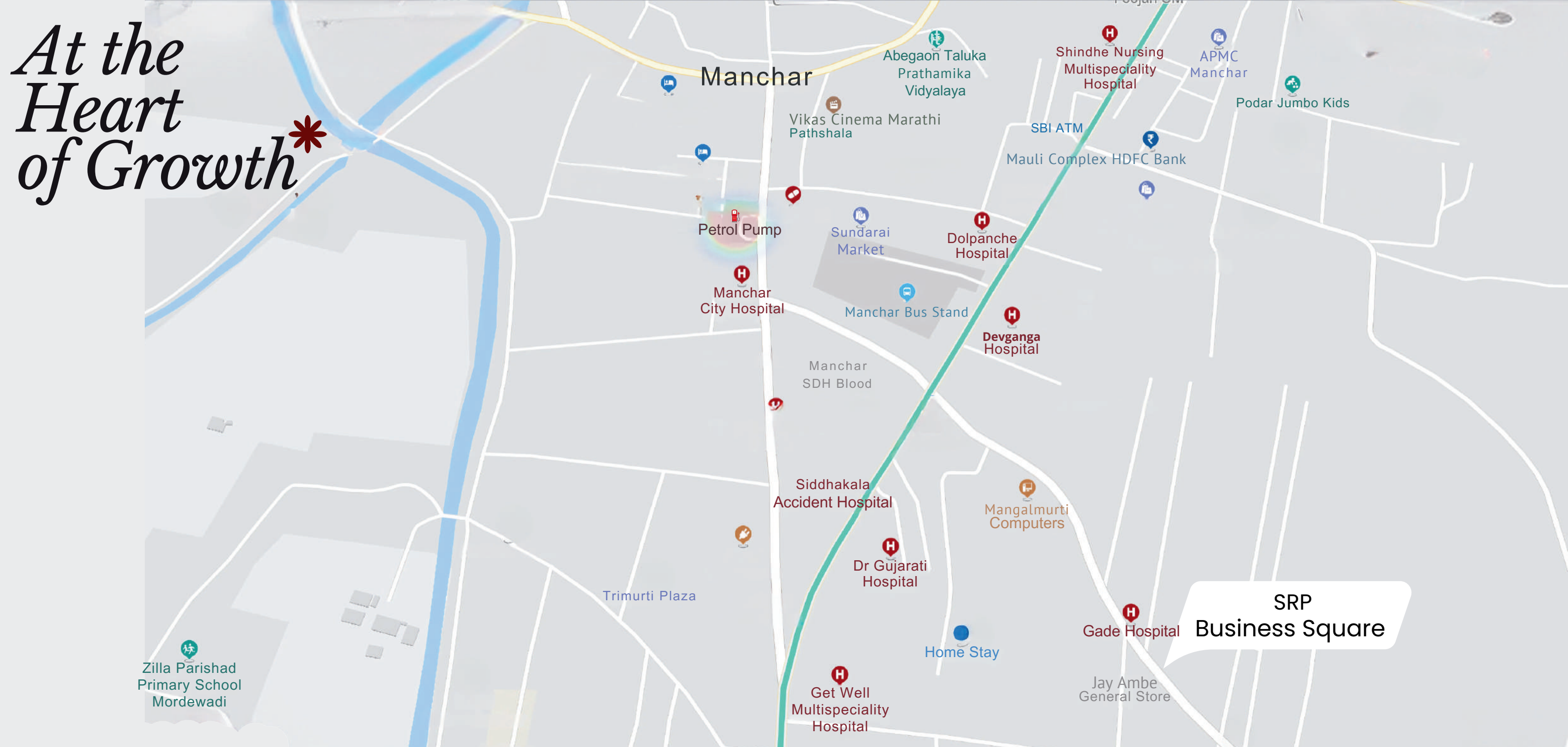



HOSPITAL 		EDUCATION 		CONNECTIVITY 	
Gade Hospital	1 Mins	NCRD'S Nalanda English Medium School	5 Mins	Nashik-Pune ighway	2 Mins
Dr. Gujrati Hospital	5 Mins	Mahatma Gandhi Vidyalaya and Junior College	4 Mins	Manchar Bus Stand	2 Mins
Seven City Hospital	3 Mins	Dr. M. A. Khan B.ED College, Manchar	7 Mins	Hp Petrol Pump	3 Mins
Sarthak Super Speciality Hospital	5 Mins	Western Institute of Paramedical Science (WIPS)	2 Mins		















# *Multipurpose Commercial Spaces at SRP Business Square*



## *Offices Spaces*

- Flexible unit plans to accommodate team sizes.
- **Proximity to public transport** and other conveniences for employees

## *Coaching Classes*

- **Spacious, well-lit units** to create an ideal learning environment.
- Proximity to residential areas ensuring easy access for students.





# Retail Stores



## Supermarket

- Spacious ground-floor units for easy customer access.
- High footfall due to **strategic location** near residential and commercial areas.

## Clothing Stores

- **Ground floor spaces** with high visibility from the street.
- Adequate signage options for brand display.s.





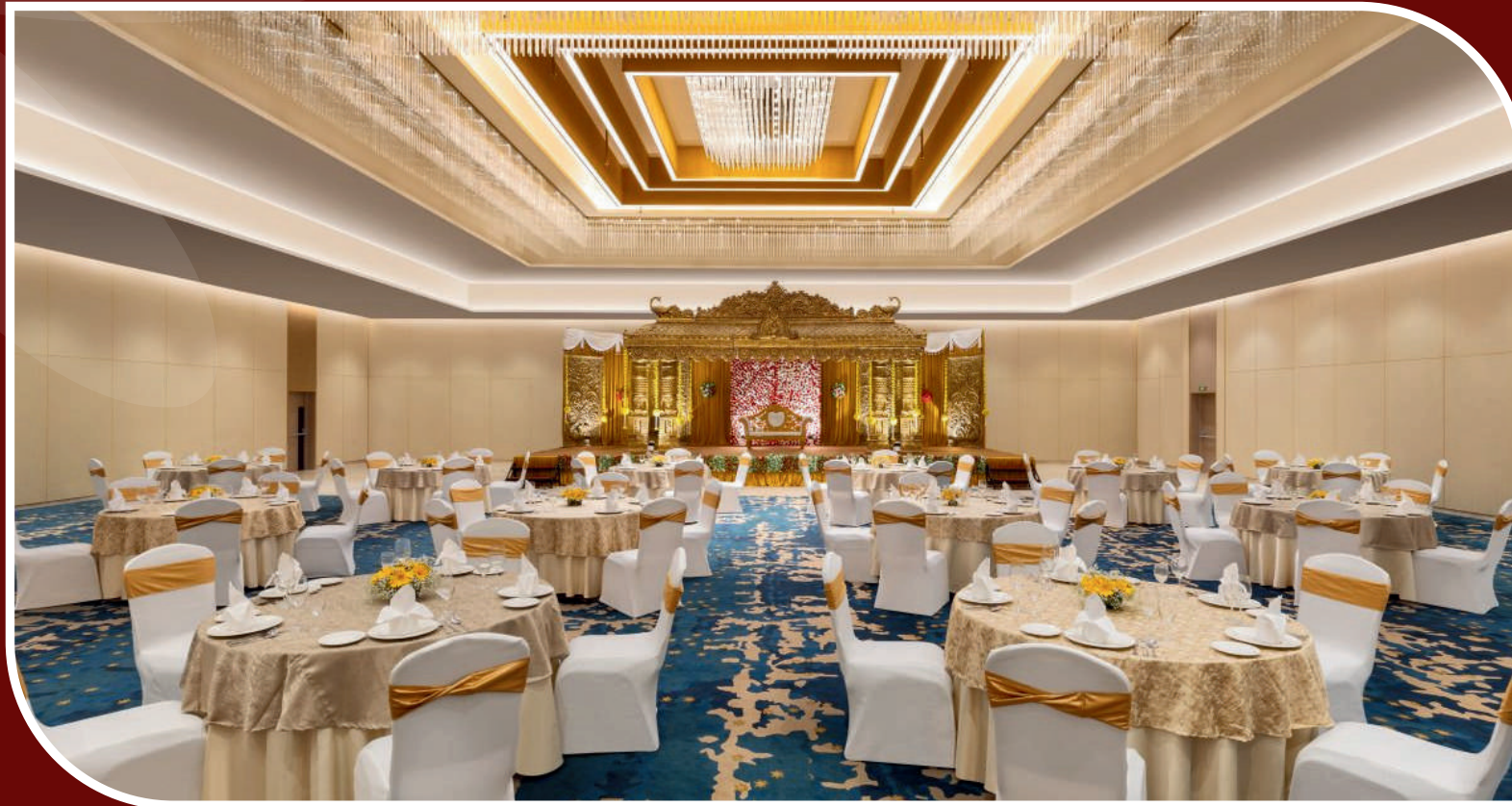

## *Banquet/Event Space*

- Dedicated parking for large gatherings.
- Modern amenities, including **elevators**, **HVAC systems**, and **power backup**.

## *Restaurant / Cafe*

- Space for outdoor seating or **rooftop dining** experiences.
- Seamless connectivity for customer convenience.







## *Salon*

- Customizable interiors to create an inviting ambiance.
- Ample parking facilities for clients.

## *Clinic*

- **Well-ventilated** spaces for a healthy ambiance.
- Flexible unit plans to customize according to medical equipment requirements.







## *Bank*

- **Secure infrastructure** with provisions for safes and ATMs.
- Proximity to residential and commercial areas ensuring steady customer flow.

## *Jewellery Store*

- Secure premises with modern safety features such as **CCTV and alarms**.
- Aesthetic storefront design for premium brand appeal.





*Designed* for Versatility \*

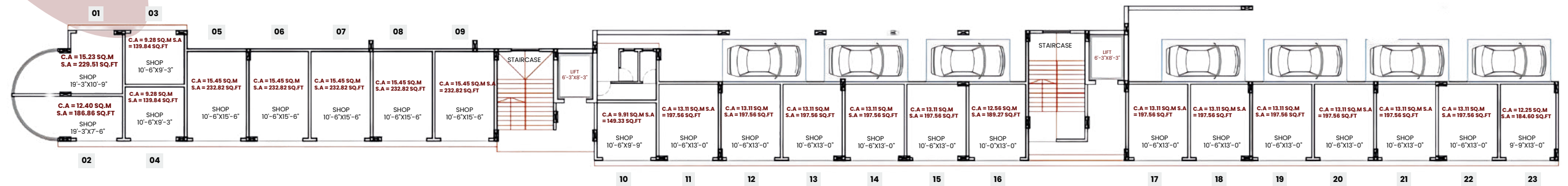

## Ground Floor Plan

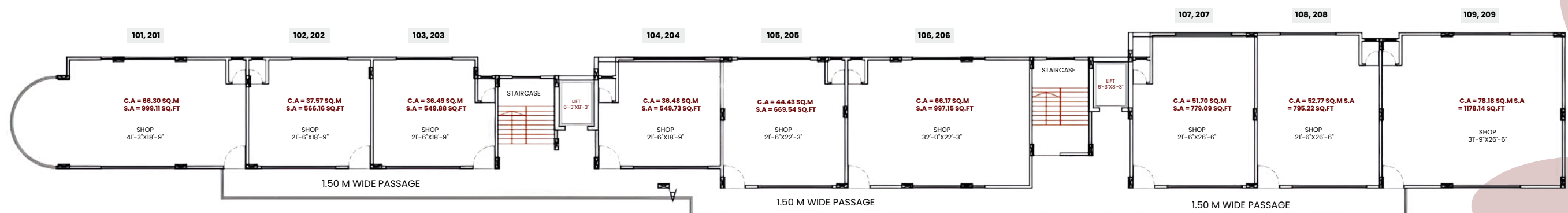

## First / Second Floor Plan

*The master layout showcases a thoughtful blend of commercial units with seamless flow and accessibility.  
Each floor is designed to maximize functionality and aesthetics.*



# Designed for Versatility \*

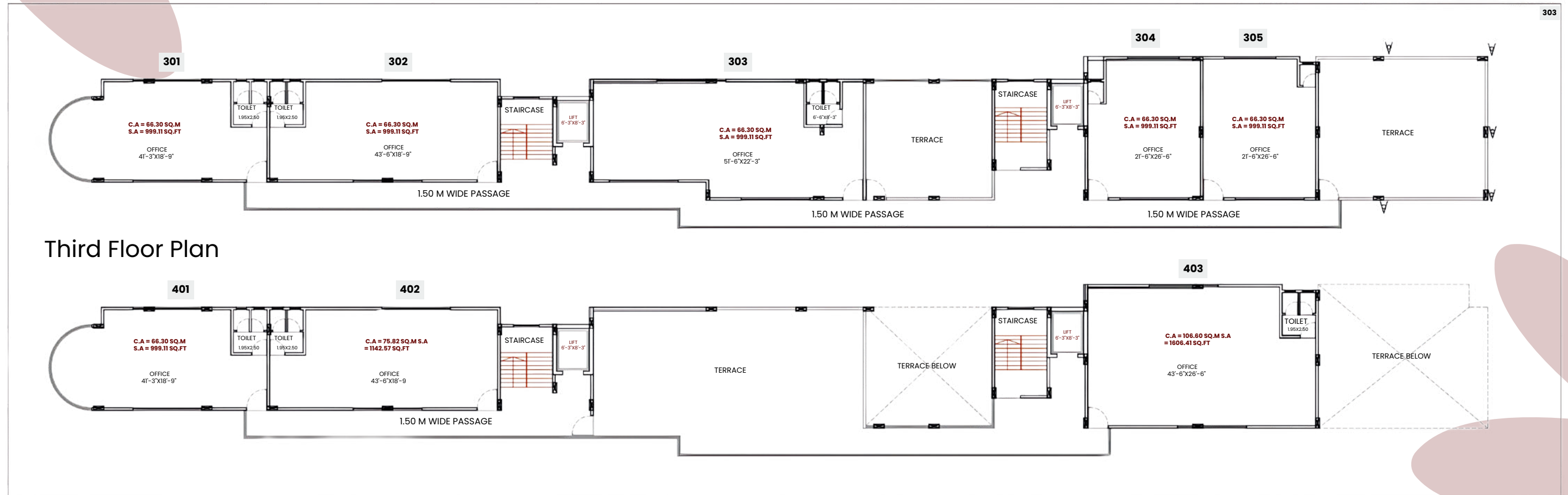

*The master layout showcases a thoughtful blend of commercial units with seamless flow and accessibility. Each floor is designed to maximize functionality and aesthetics.*



# *Spaces* that inspire\*



Our unit plans provide flexible, well-lit spaces suitable for different types of businesses.

The building design is modern, with clean lines and glass facades. These professional-looking designs are sure to leave a good impression.



# Project Specifications



## ✓ Structure

- Earth quake Resistance Seismic zone structural RCC fram
- Quality make Burnt Red Brick for internal & external Walls
- Sand Surface Plaster for walls

## ✓ Doors & Windows

- Artificial Granite for window & door Frames & Staircase
- Premium make both sides laminated post forming doors for main door
- water proof post-forming doors for bathrooms
- ISI grade UPVC windows

## ✓ Electification

- Finolex/Polycab or equivalent fire resistance wires
- Anker/legrand/goldmadal modular switches and lighting points
- Designer Surface lights in common areas

## ✓ Entrance Lobby

- Decorative Entrance Lobby with Falscelling
- Designer name plate

## ✓ Flooring & Tiling

- Branded make 600mm by 1200mm vitrified tiles for flooring
- Digital branded 600mm by 1200mm anti-skid flooring and walls in the toilet and wash area

## ✓ CP / Sanitary & Plumbing

- Jaquar or Equivalent make sanitary fittings
- Finolex or equivalent concealed pipe fittings

## ✓ Paints & Finishing

- Asian/Birla Wall care putti finishing
- Asian royal luxury emulsion paint for internal walls
- Asian apex paint for external walls





*\*USP's*

State of Art Modern  
Elevation

Branded Make  
Starcher Size SS  
Finishing Lifts

Genset Backup For  
Common Areas &  
Lifts

Fast  
Elevators





# *Flexibility*

## For Every Business

Flexible Spaces

Optimal Natural  
Light

Well-Ventilated  
Interiors

Pleasant  
Working  
Environment







# CREDITS

---

## Design Architect

YW Architect

## 3D Visualisation

3D Power

## Advertising Agency

Digidot- Brand Management Agency

# GET IN TOUCH

---

## Address

167/9 B, Mulewadi Road,  
Manchar

## Social Media & Website

srpdevelopers\_pune  
www.srpdevelopers.in

## Phone

+91 9604048192  
+91 9604048191

## Email

sales@srpdevelopers.in

Disclosure: All images are strictly for illustrative and representational purposes. The specification, pictures, images, maps, aesthetics, features, views, amenities, facilities and surroundings shown/mentioned are only for representational, illustrative and indicative purpose and the terms of the agreement for the sale (if any) if entered into by parties will solely govern, control and prevail. Prospective customers are requested to refer & satisfy themselves with respect to the sanctioned plan for the layout/project/phase/complex or visit <https://maharera.mahaonline.gov.in> for details.







---

# SRP Business Square

SHOPS | OFFICES | COMMERCIAL SPACES